

# Resolution Of The Boone County Fiscal Court

## Resolution No. 2019 – 141

**A RESOLUTION RELATING TO THE BOONE COUNTY FISCAL COURT APPROVING THE REQUEST TO VACATE STREET RIGHT-OF-WAY OF 3018-3028 THIRD STREET IN PETERSBURG, UNINCORPORATED BOONE COUNTY, KENTUCKY AS RECOMMENDED BY THE VIEWING COMMITTEE.**

**NOW, THEREFORE, BE IT RESOLVED BY THE FISCAL COURT, COUNTY OF BOONE, COMMONWEALTH OF KENTUCKY:**

### SECTION I

That Boone County Fiscal Court hereby grants the street right-of-way vacation of 3018-3028 Third Street in Petersburg in unincorporated Boone County, Kentucky per the following conditions. A Staff Memorandum dated May 22, 2019 is attached hereto as Exhibit "1".

1. The right-of-way shall be vacated to the adjoining parcels.
2. The right-of-way shall be surveyed with conveyance plats and deeds prepared for each portion of the vacation.
3. There shall be a permanent utility easement placed over the vacated right-of-way, unless releases are obtained from all applicable utility companies.
4. The owners of the adjoining parcels shall be responsible for each plat and deed preparation, but it shall be the primary responsibility of the applicant(s) initiating the right-of-way vacation to ensure all property owners comply.
5. The plats and deeds shall be reviewed by the County Attorney and the Boone County Engineer.

**SECTION II**

That this Resolution is hereby approved and adopted in Open Session of the Boone County Fiscal Court this 11<sup>th</sup> day of June, 2019.

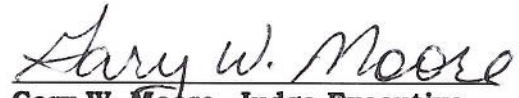
  
**Gary W. Moore, Judge-Executive  
Boone County Fiscal Court**

**Attest:**

  
**Sharon Burcham,  
Fiscal Court Clerk**

# Resolution Of The Boone County Fiscal Court

ITEM VII. C

## Resolution No. 2019 -

**A RESOLUTION OF THE BOONE COUNTY FISCAL COURT APPROVING THE REQUEST TO VACATE STREET RIGHT-OF-WAY OF 3018-3028 THIRD STREET IN PETERSBURG, UNINCORPORATED BOONE COUNTY, KENTUCKY AS RECOMMENDED BY THE VIEWING COMMITTEE.**

**NOW, THEREFORE, BE IT RESOLVED BY THE FISCAL COURT, COUNTY OF BOONE, COMMONWEALTH OF KENTUCKY:**

### SECTION I

That Boone County Fiscal Court hereby grants the street right-of-way vacation of 3018-3028 Third Street in Petersburg in unincorporated Boone County, Kentucky per the following conditions. A Staff Memorandum dated May 22, 2019 is attached hereto as Exhibit "1".

1. The right-of-way shall be vacated to the adjoining parcels.
2. The right-of-way shall be surveyed with conveyance plats and deeds prepared for each portion of the vacation.
3. There shall be a permanent utility easement placed over the vacated right-of-way, unless releases are obtained from all applicable utility companies.
4. The owners of the adjoining parcels shall be responsible for each plat and deed preparation, but it shall be the primary responsibility of the applicant(s) initiating the right-of-way vacation to ensure all property owners comply.
5. The plats and deeds shall be reviewed by the County Attorney and the Boone County Engineer.

### SECTION II

That this Resolution is hereby approved and adopted in Open Session of the Boone County Fiscal Court this 11<sup>th</sup> day of June, 2019.

\_\_\_\_\_  
**Gary W. Moore, Judge-Executive**  
**Boone County Fiscal Court**

**Attest:**

\_\_\_\_\_  
**Sharon Burcham,**  
**Fiscal Court Clerk**



RECEIVED: JSE  
6/4/19

(FOR 6/11/19 F.C.M.B.)

## Memorandum

To: Jeff Earlywine  
County Administrator

From: Scott D. Pennington, P.E.  
County Engineer/Director of Public Works

Date: May 22, 2019

Re: Vacation of Street Right-of-Way from 3018-3028 Third Street in Petersburg (Unincorporated Boone County)

ITEM VII. C  
Exhibit "1"

It is the recommendation of the Viewing Committee that the proposal for the vacation of the above-referenced dedicated right-of-way be granted per the following conditions:

1. The right-of-way shall be vacated to the adjoining parcels.
2. The right-of-way shall be surveyed with conveyance plats and deeds prepared for each portion of the vacation.
3. There shall be a permanent utility easement placed over the vacated right-of-way, unless releases are obtained from all applicable utility companies.
4. The owners of the adjoining parcels shall be responsible for each plat and deed preparation, but it shall be the primary responsibility of the applicant(s) initiating the right-of-way vacation to ensure all property owners comply.
5. The plats and deeds shall be reviewed by the County Attorney and the Boone County Engineer.

I am requesting that this recommendation be considered at the May 28, 2019 Public Hearing (prior to the Fiscal Court Meeting) as advertised and posted publicly. If you have any questions, please call.

Thank you for your consideration in this matter.

Viewing Committee Members: Cathy Flaig, Commissioner, District 1  
David A. Neff, Public Services Road Crew Leader  
Scott D. Pennington, PE, County Engineer

CC: Cathy Flaig                      Candy Fuehner  
Sharon Burcham                  David Neff  
James Horton

# Boone County GIS Map

PROPOSED  
VACATION

[www.boonecountygis.com](http://www.boonecountygis.com)

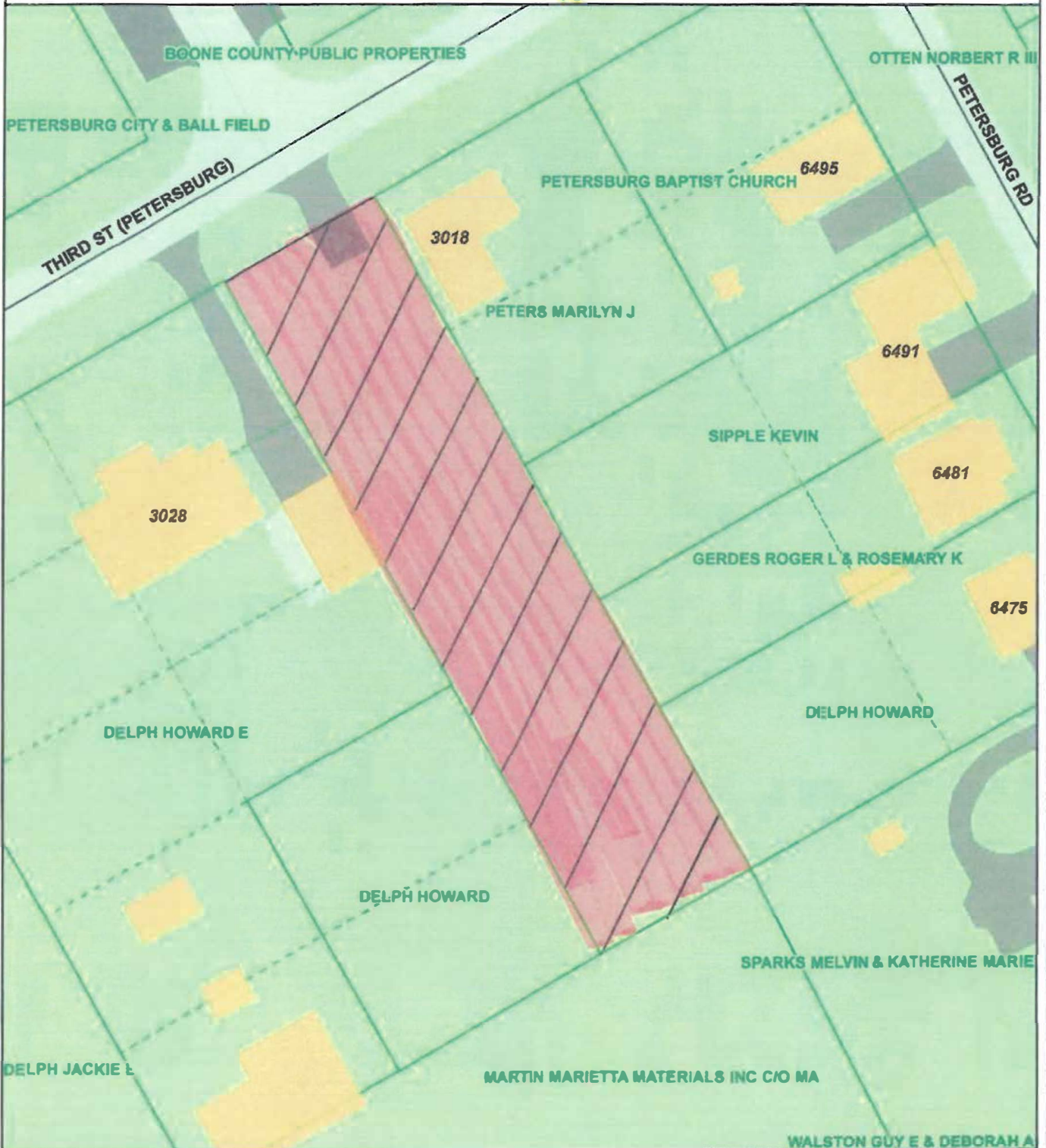

Copyright 2019 Boone County GIS. Reproduction by any means without the express permission of the Boone County Planning Commission is prohibited.

Data used to create this map were compiled from sources that comply with National Map Accuracy Standards. Boone County GIS extends no warranty with respect to the accuracy or content of the information provided by this map. This map should be used for general planning purposes only.

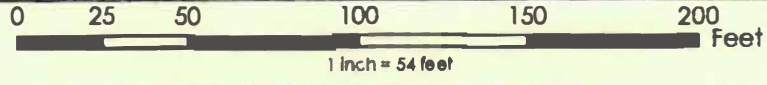

Boone County Planning Commission  
Boone County, Kentucky on the Map

Map Document 1.mxd

# Boone County GIS Map

[www.boonecountygis.com](http://www.boonecountygis.com)



Copyright 2019 Boone County GIS. Reproduction by any means without the express permission of the Boone County Planning Commission is prohibited.

Data used to create this map were compiled from sources that comply with National Map Accuracy Standards. Boone County GIS extends no warranty with respect to the accuracy or content of the information provided by this map. This map should be used for general planning purposes only.

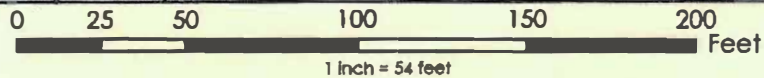

**Boone County GIS - Putting Northern Kentucky on the Map**

Map created 04/25/2019

Map Document 1.mxd